

code: 119-1



Golden
World
Trading
Group

www.GoldenWTG.org

PVDF painting Aluminum Solid Panel

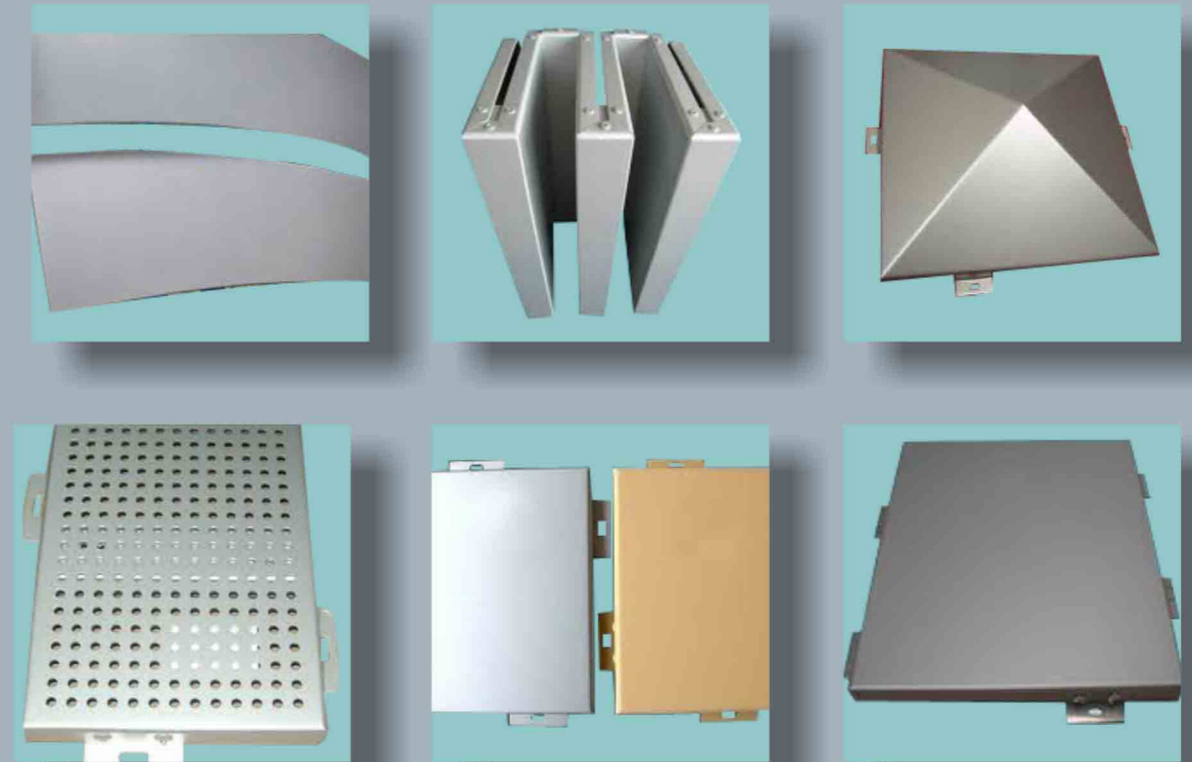
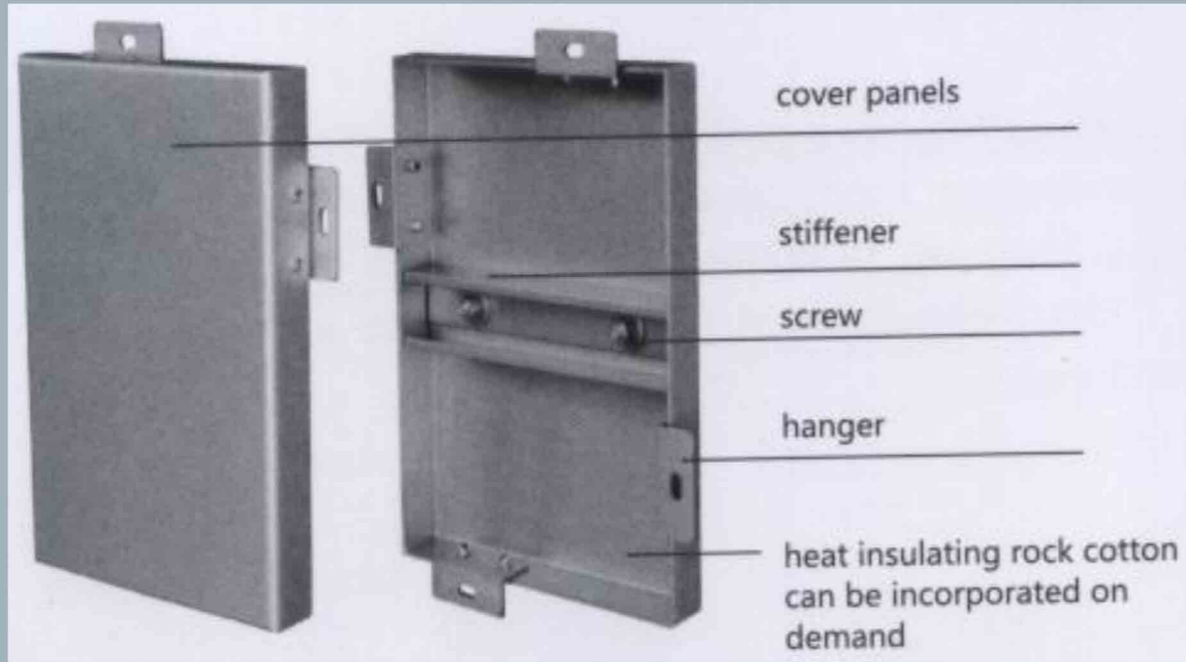

Aluminum solid panel is adopted high quality aluminum alloy materials from global well-known suppliers. Advanced CNC bending technology to ensure the panel can be formed in the processed without deformation, the superior performance against external forces during installation. Fluorocarbon spray coating equipment used by PVDF coating (PPG, AKZO or Becker) to ensure the surface of uniform color, anti-ultraviolet radiation, anti-oxidation, super corrosion resistance, impact resistance, chemical resistance and super weather resistance.

Characteristics of PVDF Aluminum panel



1. Light weight, good Rigidity, high strength

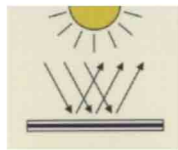

2. Excellent weathering properties and UV resistance
Excellent acid and alkali

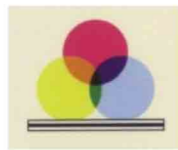

3. Various color options elegant effect



4. Easy clean & maintain

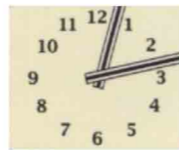

5. Easy & fast installation

PVDF aluminum panel applications

Building walls and column balconies, partitions, package decoration, interior decoration, advertising signs, cars, furniture, stands, instrument housings, instrument panels.

Conventional installation process of the curtain wall with single aluminum panels on site:

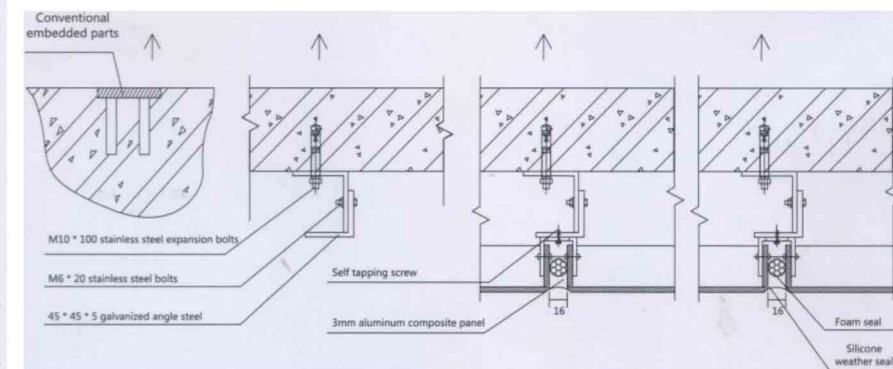
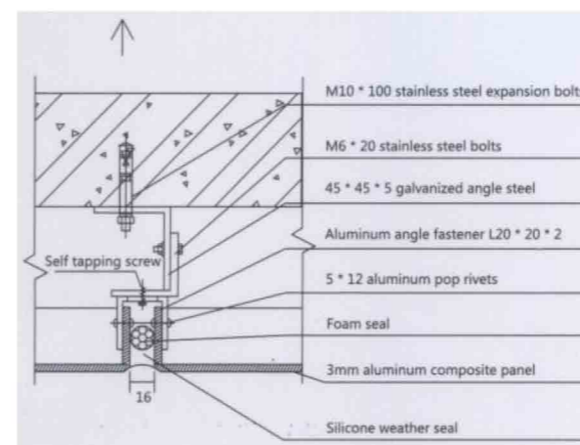
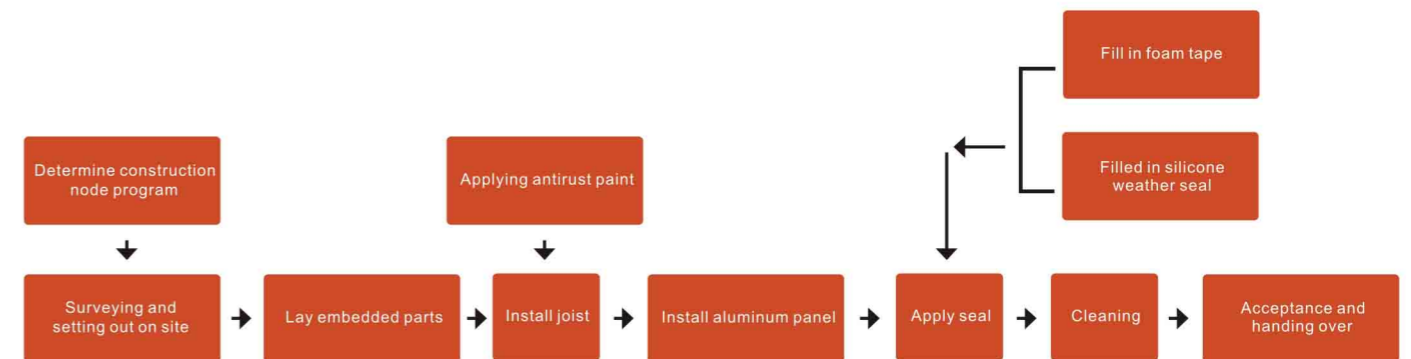

PVDF roller-coating Aluminum Sheet

Max thickness for coating sheet is just 1.5mm but now with advanced technology, coating sheet thickness is from 1.0mm to 4.0mm, and comparing with traditional powder coating aluminum solid panel, the roller-coating aluminum sheet has over-advantage as following:

- A. No color difference
- B. Perfect flatness
- C. Smooth surface
- D. Easy to clean
- E. Nice wearability
- F. Uniform coating

	Coating	Painting
Color Difference	A. The temperature difference is very small because of the height of the toaster is just 30cm. B. The temperature is fixed in one point in temperature curve when bake the surface in parallel. C. Coating in parallel. Color difference not existed	A. The temperature difference is very big because of 150cm height of the toaster. B. The temperature is not fixed but change slightly when bake in vertical. C. Painting when the product is finished, but vertical surface should be manual painted. Color difference existed
Flatness	Inner stress of the sheet will be released when it is baked the flatness can be leveled and completed. Very flat	Bake when the product is finished and inner stress cannot be released, and flatness cannot be assured. Very flat
Smooth Surface	Coating is a kind of pressing brushing coating, and there is no grain and small holes on the surface. Very Smooth	Painting is a kind of xerography system, and there are many grains and small holes on the surface. Not Smooth
Pollution	No pollution oozing because there is on grain and small holes on the surface. No pollution	Pollution oozing because there is grain and small holes on the surface. Can be polluted
Cleaning	The coated sheet can be easily cleaned by rain because there is no pollution and surface is very smooth. Easy to be cleaned	Pollution is hardly cleaned years later because there are grains and holes. Difficult to be cleaned
Wearability	Coating is made by two times coating and baking, the coating is no grain. Well Wearability	Coating is made by three times painting and baking, the coating is made of grains. Not good wearability
Coating thickness	Because of pressing coating, the pressing strength on the plate is average, and tolerance for coating is smaller than 0.5μ Thickness is average	The coating is not average on the surface because of xerography, the tolerance is about 7μ Not average

Performance contrast

between KYNAR500 fluorocarbon coating and other polymerize coating

	Kynar500	Acrylic resin	Siliconpolyester	Polyester	Plasticizedsol	Plasticizedsol	Anodising
Weathering performance							
Colour protection	☑	▲	○	×	×	▲	▲
Gloss protection	☑	▲	○	×	×	▲	▲
Anti-power resistance	☑	▲	○	×	×	▲	▲
Anti-moist performance	○	○	○	○	○	○	○
Physical performance							
Friction resistance	☑	▲	▲	×	▲	○	▲
Anti-impact performance	☑	▲	▲	▲	☑	▲	▲
Piabledegree of coating membrane	☑	×	×	▲	☑	○	×
Hardness	▲	☑	○	☑	▲	○	○
Anti-scratches	▲	○	○	○	▲	▲	○
Chemical Resistance							
Acid alk- resistant degree	☑	▲	▲	▲	×	▲	×
Anti-oil mark	☑	▲	○	○	○	▲	▲
Anti-water immersion	☑	▲	▲	▲	○	▲	○

☑ Perfect ○ Good ▲ Okay × Bad

Product specification

Specification of Products

Product	Alloy	Temper	Thickness	Width	Length
Plate&Coil	AA 1050	All Tempers	0.18-350MM	300-1950MM	Up to 8000MM/Coil
	AA 1060	All Tempers	0.18-350MM	300-1950MM	Up to 8000MM/Coil
	AA 1100	All Tempers	0.18-350MM	300-1950MM	Up to 8000MM/Coil
	AA 3003	All Tempers	0.30-350MM	300-1950MM	Up to 8000MM/Coil
	AA 3004	All Tempers	0.30-350MM	300-1560MM	Up to 8000MM/Coil
	AA 3005	All Tempers	0.30-350MM	300-1560MM	Up to 8000MM/Coil
	AA 3104	All Tempers	0.30-350MM	300-1560MM	Up to 8000MM/Coil
	AA 3105	All Tempers	0.30-350MM	300-1560MM	Up to 8000MM/Coil
	AA 5005	All Tempers	0.30-350MM	300-1560MM	Up to 8000MM/Coil
	AA 5052	All Tempers	0.30-350MM	300-1560MM	Up to 8000MM/Coil
	AA 5083	All Tempers	3.0-350MM	300-1560MM	Up to 8000MM/Coil
Roller coating Sheet	AA 3003	All Tempers	1.0-4.0MM	500-1700MM	500-6000MM
	AA 3105		1.0-4.0MM	500-1560MM	500-6000MM
	AA 5005				
	AA 5052				
	AA 5083				
AA 5754	3.0-4.0MM				
Roller coating Coil	AA 1100	All Tempers	0.3-3.0MM	30-1850MM	Up to 6000MM/Coil
	AA 1050		0.3-3.0MM	30-1850MM	Up to 6000MM/Coil
	AA 1060		0.3-3.0MM	30-1850MM	Up to 6000MM/Coil
Roller coating Sheet	AA 3003		0.3-3.0MM	30-1850MM	Up to 6000MM/Coil
	AA 3004		0.3-3.0MM	30-1560MM	Up to 6000MM/Coil
	AA 3005		0.3-3.0MM	30-1560MM	Up to 6000MM/Coil
	AA 3104		0.3-3.0MM	30-1560MM	Up to 6000MM/Coil
	AA 3105		0.5-3.0MM	30-1560MM	Up to 6000MM/Coil
	AA 5005		0.5-3.0MM	30-1560MM	Up to 6000MM/Coil
	AA 5052	0.5-3.0MM	30-1560MM	Up to 6000MM/Coil	
AA 5754	0.5-3.0MM	30-1560MM	Up to 6000MM/Coil		



PVDF roller-coating Aluminum Sheet Performance

Item of coating performance		Aluminum alloy panel	Remark	
A physical	Gloss (20/60)	15-35	JIS K5400	
	Pencil hardness	F-H	JIS K5400	
	Adhesion grid tape test	100/100		
	Adhesion grid impact test	100/100	Impact of pressure	
	Bending test	No adverse phenomenon	Bending to pressure	
	Convex impact test	No adverse phenomenon		
Weatherable gloss retention	performance	80%	Field southern exposure	
	Color change	No adverse phenomenon	Exposure period	
	Gloss retention	80%	UV laboratory	
	Color change	No adverse phenomenon	Mechanical testing	
Second properties	Spray Test	Plane 3000hours	No adverse phenomenon	5% NaCl
		Section 3000hours	No adverse phenomenon	35℃
	Wet-resistance test	No adverse phenomenon		
	Acid-resistant	No adverse phenomenon	98% RH 50℃	
	Alkali-tolerance	No adverse phenomenon	5% HCL steep for 240 hours in normal atmospheric temperature	
	Pollution-resistance	No adverse phenomenon	5% MAOH steep for 240 hours in normal atmospheric temperature	
	Wearability-tolerance	20-30mg		

Projects

S.No	Project name	Location	Consultants	Contractor	Aluminium contractor	Approx Qty M2
1	B+G+6 Hotel Building Plot No.A002-028	Dubai	DAR Consultants	AL TAAMIR Gen. Contg.	Alumetal LLC	5,000
2	DIFC Gate Village	Dubai	Hopkins Architect	Arabtec Construction LLC	Multiforms LLC	50,000
3	G+M+1 Showroom	Dubai	ARCHON	AL Bwardy Engineering Ent.	Alumetal LLC	5,000
4	Golf tower-2	Dubai	National Engr. Bureau	Al Basti & Mukha LLC	Multiforms LLC	20,000
5	The Avenues Kuwait	Kuwait	Nor Group Cons. Ltd.	Alghanim Int'l Gen. Trad.	MERO-TS K GmbH	10,000
6	Residential Bldg.G+10+PH	Sharjah	Emirates Engineering	Al Whasba Contracting	Alumetal LLC	10,000
7	Al Dafna Residential Tower	Qatar	Architectural & Engr. Con.	MZ & Partners	Valley of the Kings	40,000
8	Al Dafna Residential Tower	Qatar	Architectural & Engr. Con.	MZ & Partners	Egyptian Belgian Co.	40,000
9	Ajman Building	Ajman	Fauzi Orabi	New Vision Contracting	Alumetal LLC	4,000
10	Burj View Plot-5	Dubai	Nor Group Cons. Ltd.	Bin Laden Contracting	Multiforms LLC	16,000
11	Wafi Hotel & Mall Phase 5 Extension	Dubai	Arrif & Bintook	Khansahab Civil Engineering	Alumetal LLC	5,000
12	Movenpick Hotel & Spa & Oceana Residences	Dubai	Dar Al-Handasah	Dar Al-Handasah	Multiforms LLC	55,000
13	Ajman Expo	Ajman	Fauzi Orabi	New Vision Contracting	Alumetal LLC	10,000
14	Uniworld Headquarters Building	Jebel Ali	Kalavaal Architects	Penta Contracting Co.	Alumetal LLC	7,000
15	The Index Bldg. Project, DIFC	Dubai	Foster & Partners/ Woods	Nasa Multiplex	Multiforms LLC	35,000
16	Contructions of Zayed University	Media City	Dewan Al Emara	Engineering Contracting Co.	Alumetal LLC	7,000
17	City Hospital @ Plot no. B/P-37 @ Dubai	Dubai	SHARAFI-PHB	AL Ahmadiyah Aktor	Alumetal LLC	5,000

18	Dubai Maritime City	Dubai	ARENCO	Arabtec Constuction LLC	Alumetal LLC	3,756
19	2B+G+14 Comm'l & Resi.Bldg.@ Emirates Hill	Dubai	DUBARCH	Bin Belaila Contracting LLC	Alumetal LLC	10,000
20	Abu Ghazali Towers	Sharjah	Al Emmar Engineering	Darwish Engineering Emirates	Alumetal LLC	13,916
21	S-20603 Jafza	Dubai	Green Line International	Core Construction Company	Alumetal LLC	11,143
22	S-20603 Jafza	Dubai	Green Line International	Core Construction Company	Alumetal LLC	5,000
23	Al Habtour Plaza, Dubai Festival City	Dubai	Al Futtaim Carillion	Al Burj Engineering & Cons.	Multiforms LLC	7,000
24	Albwardy Club House @ Awir Polo	Dubai	ARCHON	Albwardy Engineering LLC	Alumetal LLC	2,000
25	IBIS & Movetel Hotels @ Port Saeed, Dubai	Dubai	ATKINS	Khansahab Civil Engineering	Alumetal LLC	2,423
26	Motor City-automall	Dubai	Burt, Hill	Nasa Multiplex	Multiforms LLC	45,000
27	IBIS & Suit Hotels @ Al Barsha, Dubai	Dubai	hatib & Alami Cons. Engr.	Khansahab Civil Engineering	Alumetal LLC	4,609
28	Dubai Marina Mall (Ns01)	Dubai	DP Architects PTE LTD	Al Jaber Engr. & Cont. (ALEC)	Multiforms LLC	22,000
29	Hotel JAL Tower Dubai 1B+G+1M+49 Floor+4Mech+	Dubai	Dimension Consultant Architect	Aerated Concrete Industries	(ALICO) Alum.	60,000
30	IBIS Hotel	Dubai		Dutco Balfour Beatty LLC	Multiforms LLC	12,000
31	Dubai Marina Mall Louvers (Ds04)	Beirut	Khatib & Alami Cons. Engr.	Al Jaber Engr. & Cont. (ALEC)	Multiforms LLC	10,000
32	WATERFALLS MALL	Dubai	DP Architects PTE LTD	Al-Ahlia Contracting Group	Alico Kuwait	7,000

33	Emaar Boulevard Plaza Burj Dubai Plot 12&13	Dubai	Nezar Al Anjari Consulting B.	Samsung Baytur Corporation	Multiforms LLC	14,000
34	The Lofts-Burj Dubai Development	Dubai	AEDAS (Rep. Office)	Al Futtaim Carillion	Multiforms LLC	8,000
35	Castle House-London Project	UK	Noor Group Cons. Ltd	Multiplex Development (UK) LTD	Multiforms LLC	15,000
36	King Abdullah University of Science & Technology	KSA	WSP Group	Saudi Oger LTD.	Multiforms LLC	52,000
37	Dubai Maritime City(Labour Accom. Complex)	Dubai	Oger International/Hok	Pauling Middle East Co. LLC	Multiforms LLC	12,000
38	Dubai Health Care City Hotel	Dubai	Arence	Al-Basti & Muktha LLC	Multiforms LLC	15,000
39	Renaissance Hotel @ Motor City	Dubai	Robert Matthew, Johnson	Nasa Multiplex	Multiforms LLC	18,000
40	Nad Al Shiba Race Course	Dubai	Burt, Hill	Arabtec Construction LLC	Multiforms LLC	30,000
41	Salam Plaza	Doha Qatar	Teo A. khing Design Cons.	Alunasa WLL	Alunasa W.L.L.	10,000
42	Navigation Tower	Doha Qatar	Salam studio & Store	Hill Int'l Limited Co.	Alunasa W.L.L.	6,000
43	Cayan Building	Doha Qatar	MAZ & Partners & Saz Const.	Test contracting Co.	Wall technology	7,000
44	MAF Hospitality Tower	Dubai	Schuster Pechtold	Khansaheb	Multiforms LLC	6,000
45	3 TOWERS(X1,X2,X3, towers)	Dubai	NEB	Belhasa Cont.	AL FAYHA ALUMINIUM	21,006
46	2037 TIARA RESIDENCES	Dubai		Arabtec Construction LLC	Multiforms LLC	5,000
47	2020 INDEX TOWER	Dubai	Norman Foster & Patners	Multiplex	Multiforms LLC	30,000
48	TORCH TOWER 80th FLOOR	Dubai	National engr. Bureau	Dubai Civil Engineering	Al Hamad Construction	40,000

TO THE SAME GOAL
KEEP AHEAD
 TO THE SAME DREAM , FIGHT SIDE BY SIDE